

**CURIO COLLECTION**  
by Hilton

LEVEL 1

PAGE 1

(504) 528-1941 • 1000 MAGAZINE ST, NEW ORLEANS LA 70130 • HIGGINSHOTELNOLA.COM

ANDREW HIGGINS DRIVE

MAGAZINE STREET

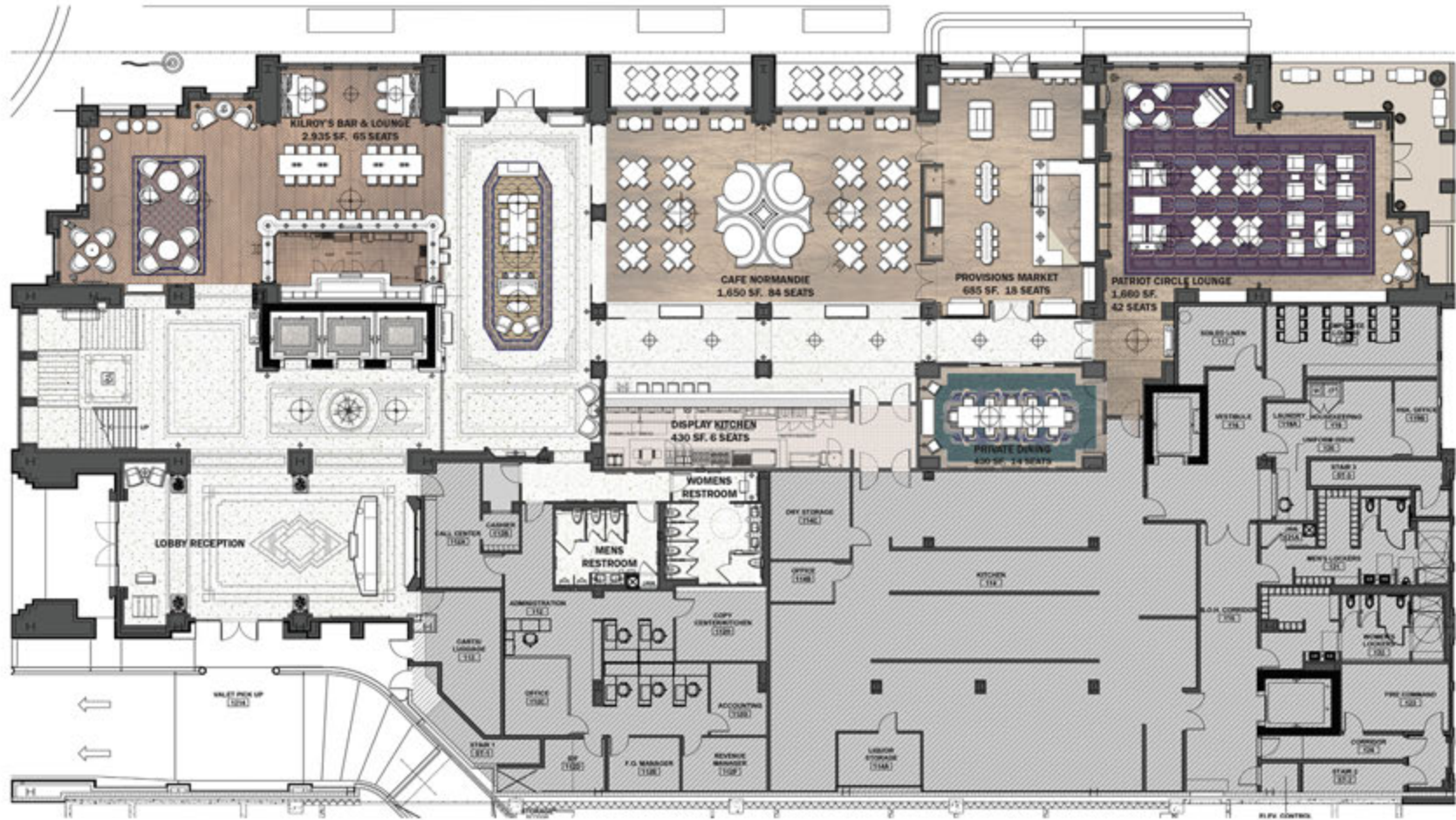

CONSTANCE STREET



CURIO COLLECTION  
by Hilton

LEVEL 1 OVERALL FLOORPLAN

PAGE 2

(504) 528-1941 • 1000 MAGAZINE ST, NEW ORLEANS LA 70130 • HIGGINSHOTELNOLA.COM

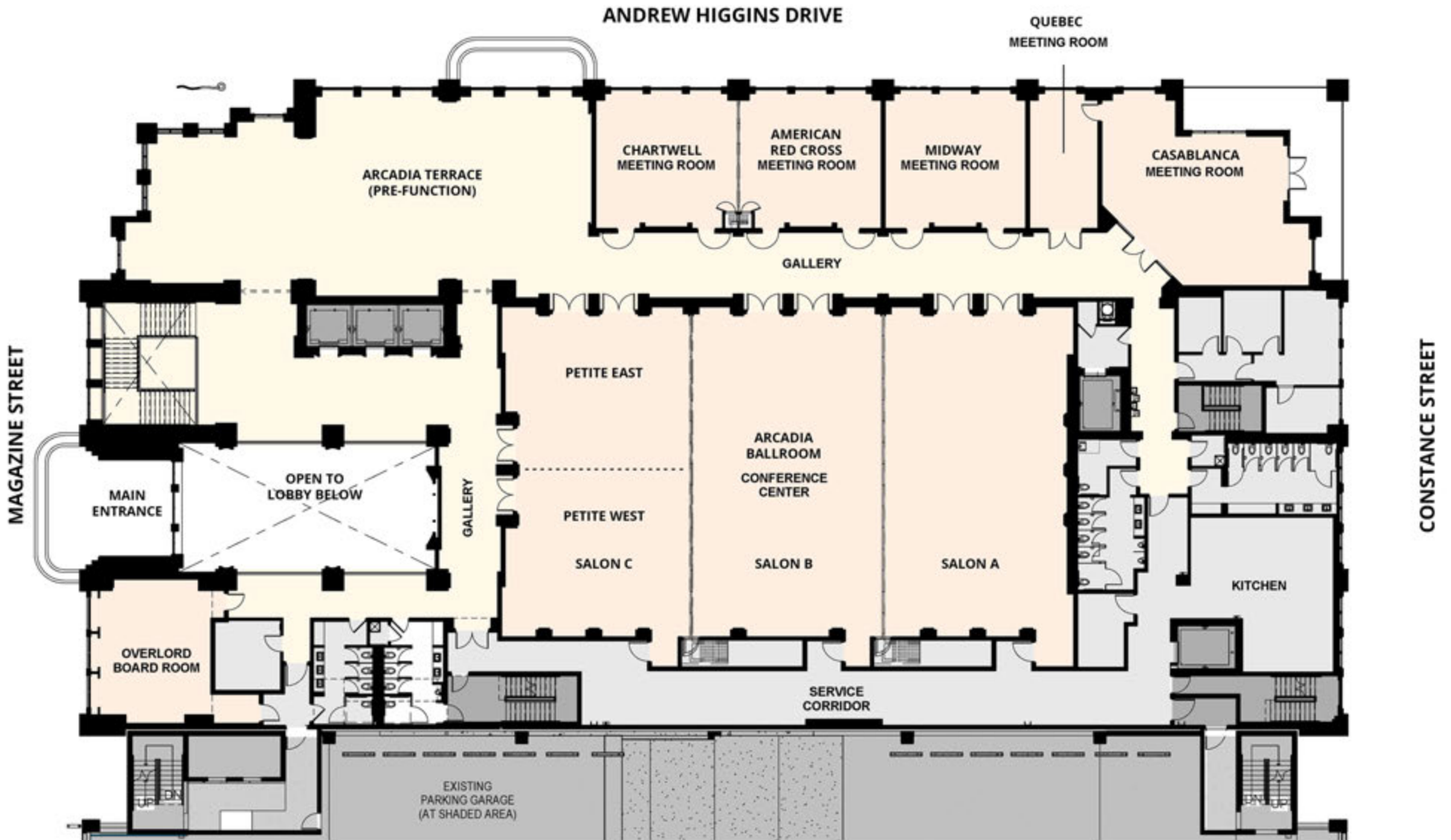

**CURIO COLLECTION**  
by Hilton

LEVEL 2

PAGE 3

(504) 528-1941 • 1000 MAGAZINE ST, NEW ORLEANS LA 70130 • HIGGINSHOTELNOLA.COM

ANDREW HIGGINS DRIVE

MAGAZINE STREET

CONSTANCE STREET

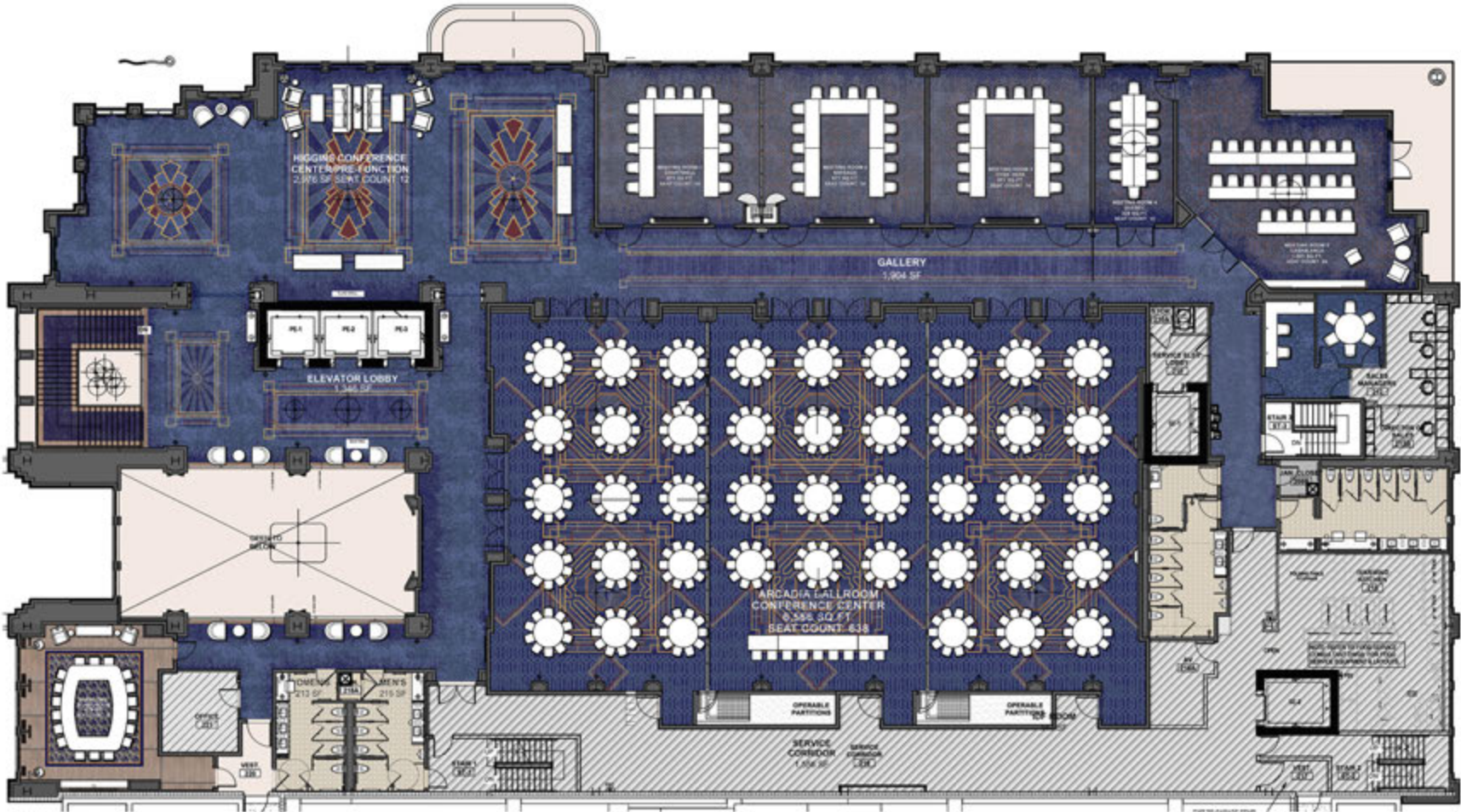

CURIO COLLECTION  
by Hilton

LEVEL 2 OVERALL FLOORPLAN

PAGE 4

## HIGGINS HOTEL & CONFERENCE CENTER MEETING & SPACE CAPACITY CHART

AREA	Dimensions (LxW)	Ceiling Height	SQ FOOTAGE	Crescent Rounds 5	CONFERENCE	USHAPE	CLASSROOM	THEATER	RECEPTION	BANQUET 72"
OVERLORD BOARD ROOM	25x22	14'6" (16@peak)	550	NA	16	NA	NA	NA	NA	NA
ARCADIA Terrace (PRE-FUNCTION)	86x38	15(18@peak)	2925	100	NA	NA	NA	200	350	200
Arcadia GALLERY	97x15	15'3"(17'2"@peak)	982	NA	-	NA	-	-	-	-
Lobby Overlook GALLERY	61x50	16'(34@peak)	1658	NA	-	NA	-	-	-	-
CHARTWELL MEETING ROOM	26x25	17'(11'8"@peak)	650	30	24	28	32	80	60	50
AMERICAN RED CROSS MEETING ROOM	26x25	17'(11'8"@peak)	650	30	24	28	32	80	60	50
MIDWAY MEETING ROOM	26x25	17'(11'8"@peak)	650	30	24	28	32	80	60	50
QUEBEC MEETING ROOM	25x12	17'(11'8"@peak)	300	10	20	14	12	30	30	20
CASABLANCA MEETING ROOM	39x33	17'(11'8"@peak)	975	40	24	28	75	100	90	80
Casablanca Outside Terrace		20' nominal (exterior)	390	NA	NA	NA	NA	NA	25	NA
Arcadia SALON A	60x35	17'2"(18'6"@peak)	2136	90	50	60	80	240	300	150
Arcadia SALON B	60x35	17'2"(18'6"@peak)	2194	90	50	60	80	240	300	150
Arcadia SALON C	60x35	17'2"(18'6"@peak)	2085	90	50	60	80	220	280	150
* Petit SALON C East	34x31	17'2"(18'6"@peak)	1007	40	30	32	40	110	130	80
* Petit SALON C West	34x31	17'2"(18'6"@peak)	1078	40	30	32	40	110	130	80
Rosie's on the Roof Total (existing seating)			1950		NA	NA	NA	NA	200	NA
* Rosie's on the Roof Interior Bar Area					NA	NA	NA	NA	48	NA
* Rosie's on the Roof Terrace		exterior			NA	NA	NA	12	140	NA
SAINTE-MÈRE-ÉGLISE PRIVATE DINING ROOM			432	na	16	NA	NA	na	20	30 Banq
<b>TOTAL</b>			20612						1956	
*Actual Total excluding C East and C West			18170							
<b>Combination Rooms</b>										
ARCADIA BALLROOM (A+B+C)	105x60	17'2"(18'6"@peak)	6566	225	150	180	380	675	650	450
ARCADIA BALLROOM (A+B)	60X70	17'2 (18'6"@peak)	4200	180	80	100	250	480	450	350
Red Cross/Chartwell Combo Room	26x50	17'(11'8"@peak)	1300	60	40	30	70	160	120	120
Arcadia Salon C (Petit East + Petit West)	60x35	17'2"(18'6"@peak)	2085	90	50	60	120	240	220	150

\*Blue Shaded cannot be rented as individual private space, but only in conjunction with other space.

